

Job or Customer :	
Location :	
Engineer :	
<input type="checkbox"/> Complies with Spec <input type="checkbox"/> Alternate	Notes :
Contractor :	
HeatLink Rep :	
Submitted By :	Date :
Approved By :	Date :
P.O. Number :	Date :

### Description

Low resistance valve provides on/off or modulated flow control for baseboard, fan coils, manifolds, or injection controls. Threads are compatible with actuators #56201, #56231, #56121, #56401, and thermostatic head #57094.

### Noise behavior

To ensure low-noise performance, the following conditions must be met:

- On the basis of experience, the differential pressure over the thermostatic valves should not exceed about 6.7 ft head / 0.2 bar. If in designing the system, higher transient differentials might be experienced in the partload flow range, differential pressure control equipment such as 600xx series pressure bypass valves can be used.
- Mass-flow must be correctly adjusted.
- The system must be completely deaerated.

### Technical Data

#### Material:

Valve body: ..... Corrosion resistant bronze  
O-rings: ..... EPDM rubber  
Valve disc: ..... EPDM rubber  
Return spring: ..... Stainless steel  
Valve insert: ..... Brass  
Spindle: ..... Niro-steel spindle with double O-ring sealing  
Surface Treatment: ..... Nickel plated body and fittings (#62216 and #62220 only)  
Max. Operating Temperature: ... 248°F (120°C)  
212°F (100°C) with protection cap or actuator  
Min. Operating Temperature: ... 14°F (-10°C)  
Max. Operating Pressure: ..... 10 bar / 335 ft head  
Actuator Thread: ..... M 30×1.5

### Installation

Installation must follow all of HeatLink's instructions and guidelines, including those in the Installation Guide.

### Related Documents

- HeatLink Installation Guide (L3390)
- HeatLink Limited Heating Warranty

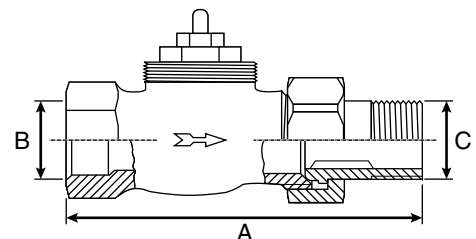

Qty	Size	Stk. #	Dimension			Cv	Kv	Max Pressure differential across (closed) valve with actuator:			Weight
			A	B	C			57091/4	56121	56200 Series	
	½"	62016	3-¾" (95 mm)	½" FNPT	½" MNPT	2.9	2.5	20 ft head 0.6 bar	47.5 ft head 1.4 bar	47.5 ft head 1.4 bar	0.66 lb 0.3 kg
	½"	62216	3-¾" (95 mm)	½" FNPT	½" MNPT	2.3	2.0	33.5 ft head 1 bar	117.1 ft head 3.5 bar	117.1 ft head 3.5 bar	0.5 lb 0.23 kg
	¾"	62220	4-¾" (106 mm)	¾" FNPT	¾" MNPT	2.9	2.5	33.5 ft head 1 bar	117.1 ft head 3.5 bar	117.1 ft head 3.5 bar	0.5 lb 0.23 kg
	1"	62025	4-⅝" (118 mm)	1" FNPT	1" MNPT	6.6	5.7	8.4 ft head 0.25 bar	26.8 ft head 0.8 bar	26.8 ft head 0.8 bar	1.7 lb 0.77 kg
	1-¼"	62030	5-⅝" (135 mm)	1-¼" FNPT	1-¼" MNPT	6.8	5.8	8.4 ft head 0.25 bar	15.8 ft head 0.47 bar	15.8 ft head 0.47 bar	2.4 lb 1.09 kg

*This page is intentionally blank.*